

# Mounting system for your glasscomposition type A

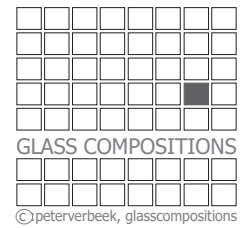

Congratulations with your just required unique glas object.  
Please read text and explanation below for a smooth mounting in order to enjoy for many years your new colour-composition.

We recommend to place a blanket or other soft material on the ground to place the object on during the installation.  
Also leave the protection corners on until final hanging is achieved.

Required tools:

measurer, spirit-level, 6- and 8mm stone drillbits, drillingmachine and a phillips-head screwdriver.

## Attention; Type of wall:

- a. Stone- or concrete walls: Use supplied fixing materials.
- b. Plasterboard walls: Require additional special fixingplugs («Driva or Fischer») to fit the supplied screw sizes/dimensions.
- c. Ytong or Gypsum walls: Use metal drillbits instead of stone bits, attach with the supplied plugs and screws.
- d. Wooden walls: Use supplied screws for fixing without plugs.

Please check if there are no water, gas or electricity pipes in the selected drill- positions.

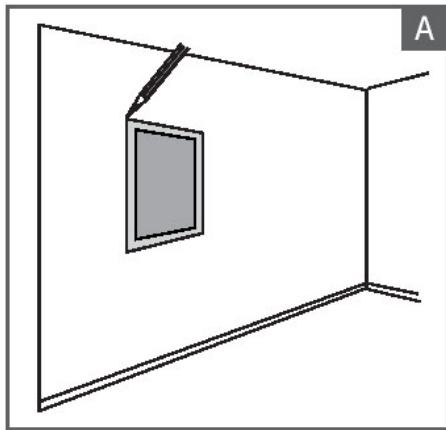

Mark position on wall, to avoid damages: leave corner-protectors on.

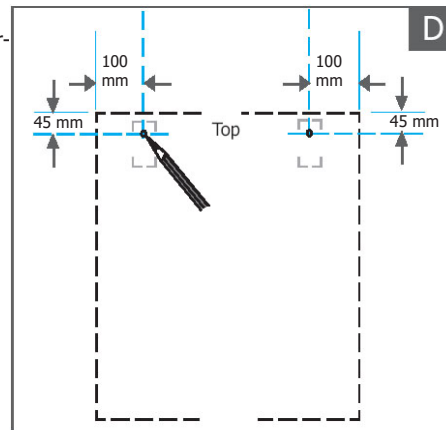

Position and mark drillpositions for top end as indicated.

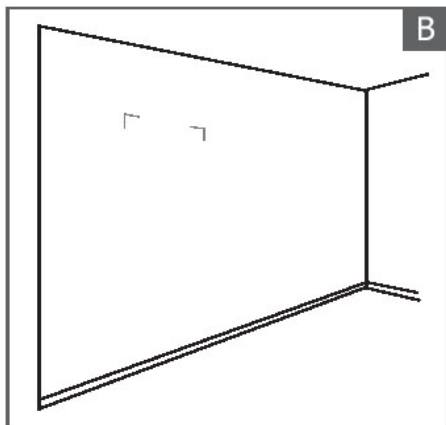

You can also measure your object and mark corners directly onto the wall.

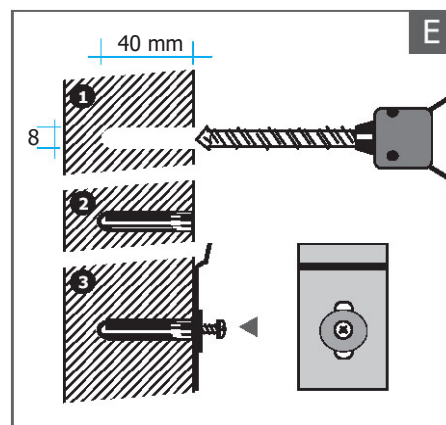

Drill 8 mm holes and fix mounting-plates (with washer on the outside) with plugs and screws.

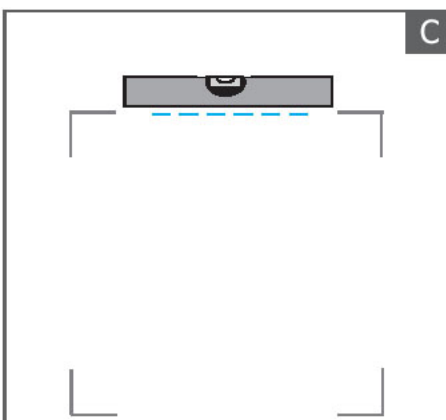

Make sure potential topline of your object is levelled.

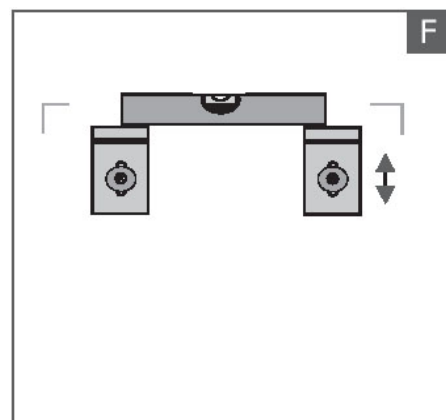

Check if levelled, otherwise adjust one.

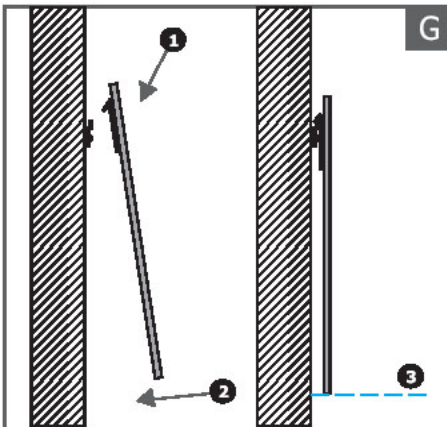

**G** Mark position of bottom-end on wall, to avoid damages leave corner-protectors on.

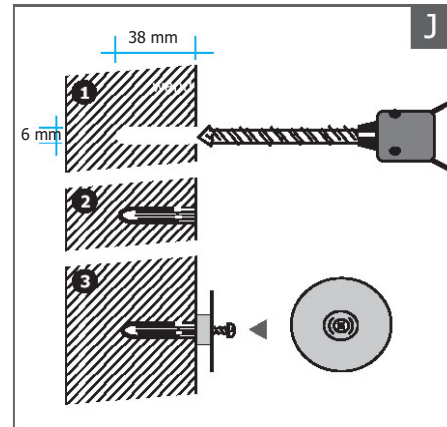

**J** Drill 6 mm holes (38 mm deep) and fix with plugs and screws with round button facing the wall.

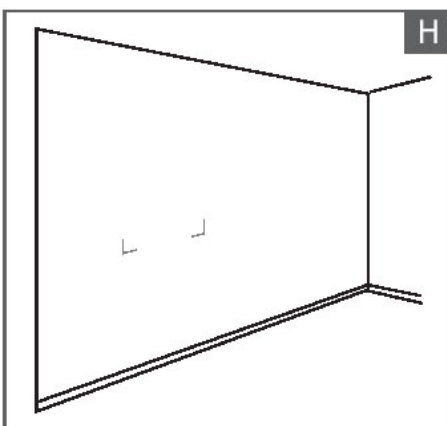

**H** Before you take off the object, check if leveled, otherwise adjust ( see F).

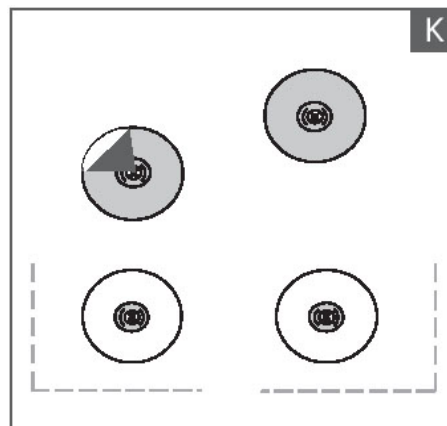

**K** Remove protecting paper and aline buttons with marked edges.

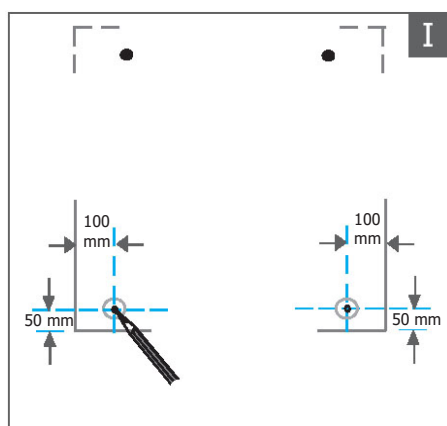

**I** Mark drill positions for bottom fixing as indicated.

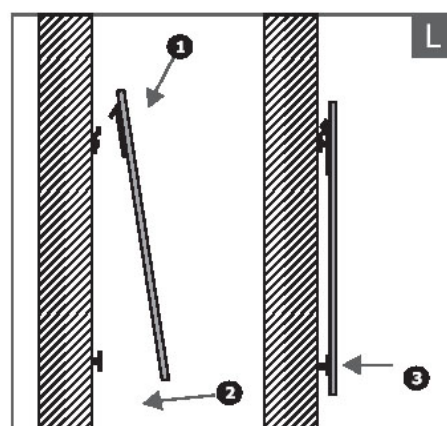

**L** Hang object and push firmly at bottom end to attach bottom fixings to your object.

In case you would like to remove or replace: Pull at the bottom end to release the fixing buttons and lift object to unhook at the top. The round buttons at bottom end will stay on the wall and the square plates will sit on the object. At re-installing just hang in and click bottom end into buttons.

**Attention:** we recommend to clean glasscompositions with a dry cloth or a moist wash leather by just lightly wipe them off. Never use cleaners or chemicals.

Also please be aware this is a unique piece all hand-cut and made so slight imperfections just indicate you have a genuine artefact at hand. When you stay to all this you will enjoy your composition for many, many years.

In case of any additional questions please contact by e-mail